

Product End of Life Instructions

**Variable speed drive, Altivar Machine ATV320, 4 kW, 380...500 V,
3 phases, compact**

Altivar Machine ATV320 / Altivar Solar





Potential disassembly risks

The information provided in this document assumes that the product is completely de-energized and uninstalled (refer to the instructions provided in the appropriate product manuals).

Dismantling/disassembling the product may entail hazards caused by, for example, sharp edges, chemical aggression or ejected parts.

▲ WARNING

HAZARD DUE TO INSUFFICIENT PROTECTION

- Implement all safety measures required by the applicable regulations and by the processes used to dismantle/disassemble and dispose of the product.
- Use all necessary personal protective equipment such as gloves and goggles.

Failure to follow these instructions can result in death or serious injury.

End of Life Instructions

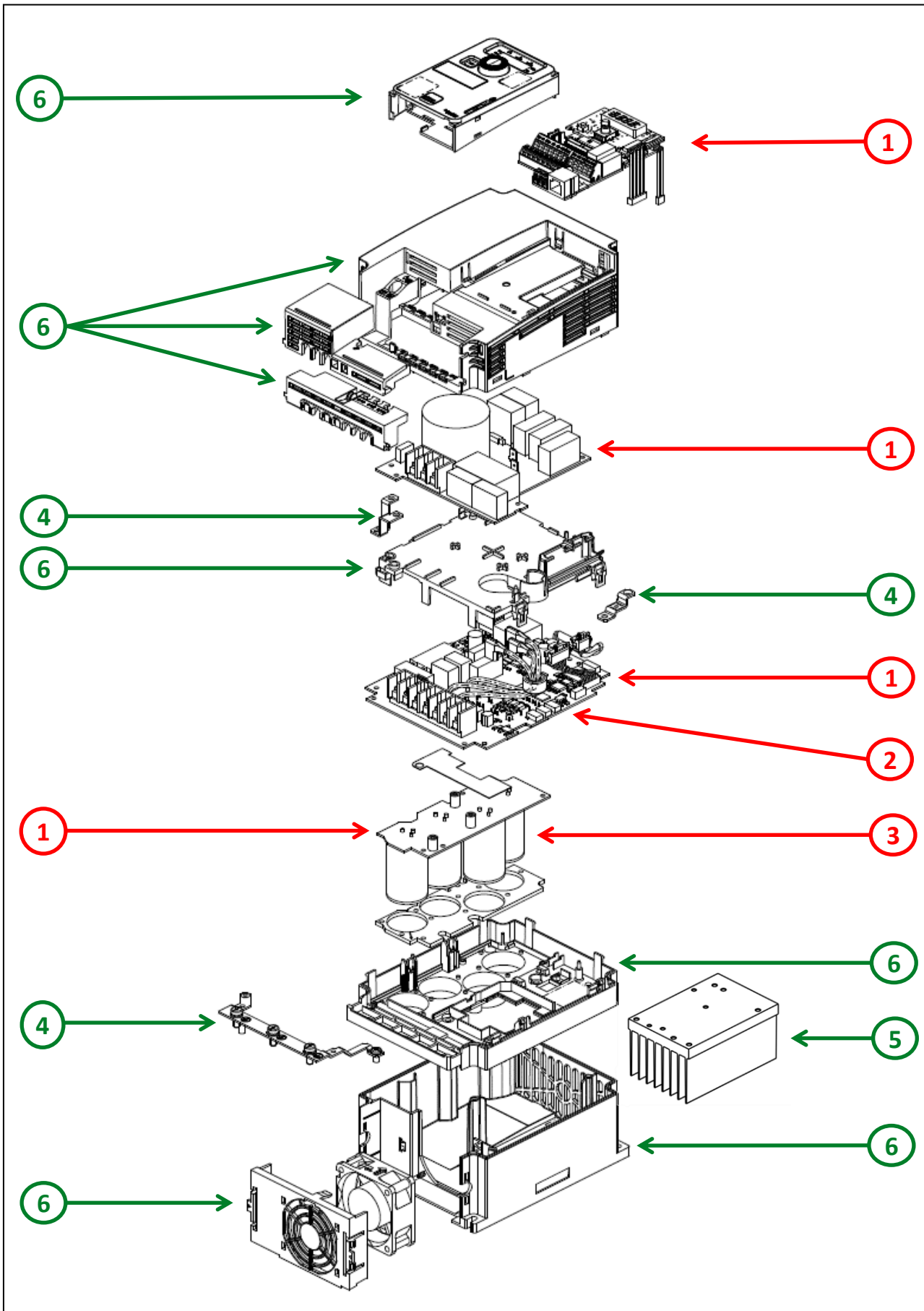

ENVEOLI1512005_V1 - End of Life Instructions - Variable speed drive, Altivar Machine ATV320, 4 kW, 380...500 V, 3 phases, compact

Recommendation	Number on drawing	Component / Material	Weight (in g)	Comment
To be depolluted	1	Electronic Board (Power and Communication) > 10cm ²	686,65	
To be depolluted	2	Cable (high current)	40	
To be depolluted	3	Electrolyte capacitors which size: height > 25 mm, diameter > 25 mm or proportionately similar volume	184	
To be dismantled	4	Steel	123	Grounding Bar - Grounding Plate
To be dismantled	5	Aluminium	394,5	Heatsink
To be dismantled	6	PC, ABS-PC, PA, PA6, HDPE, SAN with or without additive, PP+EPDM and PP	664	Housing - Control Support- Fan Support - Filter Support - Control Door -Chassis - Wiring CAP - Wiring Trap
Other			107,85	



Product description

Manufacturer identification	Schneider Electric Industries SAS
Brand name	Schneider Electric
Product function	The main function of the Altivar Machine product range is the speed control and variation of a synchronous, asynchronous or reluctance electric motor for fluid management and industrial applications.
Product reference	ATV320U40N4C
Total representative product mass	2,2 kg
Representative product dimensions	184mm x 140mm x 158mm
Accessories	No accessories needed.
Date of information release	07-2024



Additional information

Legal information	The product family must be disposed according to the legislation of the country. This document is intended for use by end of life recyclers or treatment facilities. It provides the basic information to assure an appropriate end of life treatment for the components and materials of the product.
In case of special transportation: transportation method	No special transportation.
Recyclability potential	58% Recyclability rate has been calculated based on REEECYLAB tool developed by Ecosystem, for components/materials not covered by the tool, data from the "ECO'DEEE recyclability and recoverability calculation method" was taken. If no data was found a conservative assumption was used (0% recyclability).

Schneider Electric Industries SAS

Country Customer Care Center

<http://www.se.com/contact>

35, rue Joseph Monier

CS 30323

F- 92500 Rueil Malmaison Cedex

RCS Nanterre 954 503 439

Capital social 928 298 512 €

www.se.com

ENVEOLI1512005_V1

Published by Schneider Electric

© 2023 - Schneider Electric – All rights reserved

07-2024