

Product End of Life Instructions

Connected Double Socket Outlet

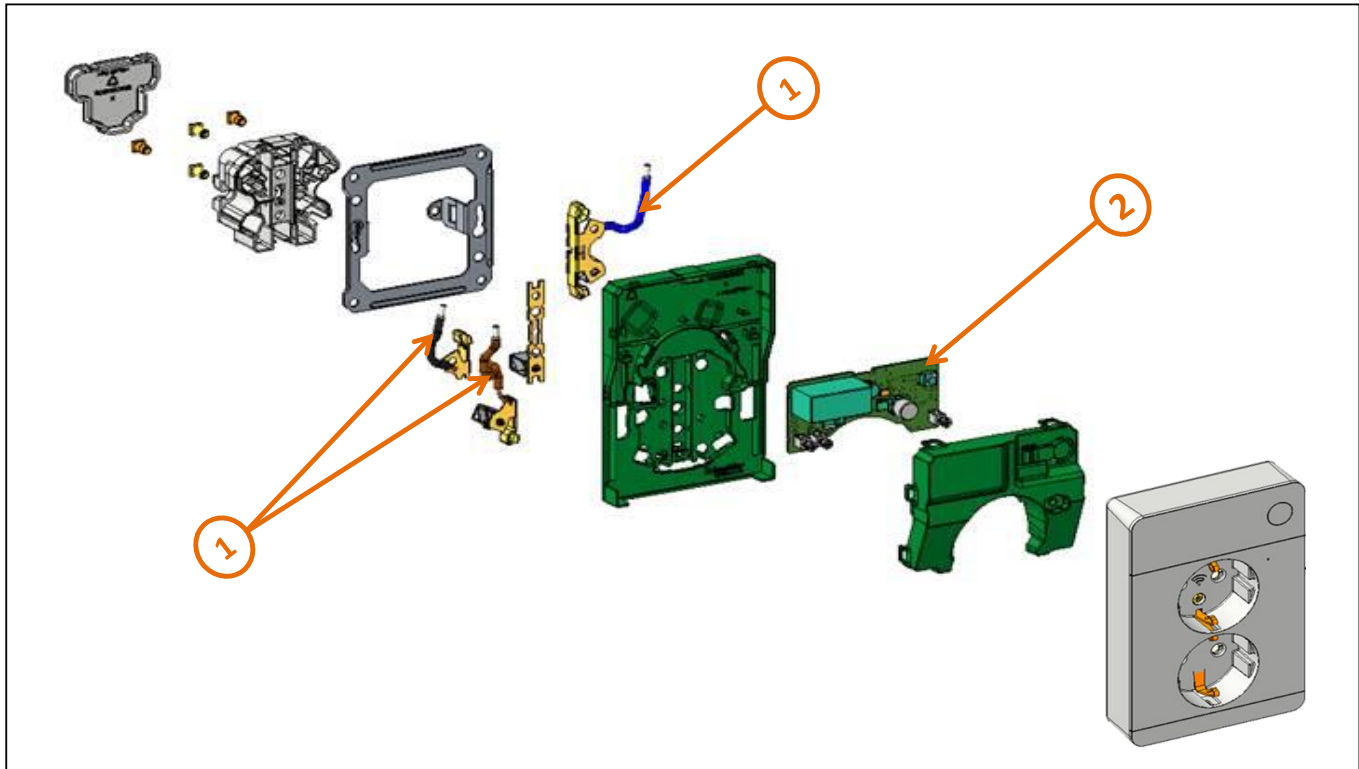

End of Life Instructions



Recommendation	Number on drawing	Component / Material	Weight (in g)	Comment
To be depolluted	1	Cable (low current)	5.3	Wire
To be depolluted	1	Electronic Board (Power) > 10cm ²	30	PCBA

Product description

Manufacturer identification	Schneider Electric Industries SAS
Brand name	SCHNEIDER ELECTRIC
Product function	<p>The Connected double socket outlet 16A is equipped with a standard and a smart socket with clear marking of Wiser Smart icon for identification.</p> <p>Use in new build or retrofit installation for controlling electrical devices through the push button on the device, app or by voice command (Amazon Alexa, Google Home). Fully compatible with Schneider Electric Wiser platform with extensive functionalities such as energy monitoring, scheduling, timer, automation, moments and much more. With the upper, smart socket you can control and monitor the plugged-in load.</p> <p>The lower, standard socket provides uncontrolled and unmonitored power. The device is equipped with a temperature protection mechanism. When the device is used with a high load over a long time, the mechanism can switch the smart socket off.</p>
Product reference	WDE002182
Total representative product mass	200 g
Representative product dimensions	126mm x 85mm x 50mm
Accessories	No
Date of information release	07/2021



Additional information

Legal information	<p>This product family is in the scope of European Union directive 2012/19/EU on Waste Electrical and Electronic Equipment (WEEE). The product family must be disposed according to the legislation of the country. This document is intended for use by end of life recyclers or treatment facilities. It provides the basic information to assure an appropriate end of life treatment for the components and materials of the product.</p>	
Recyclability potential	14%	<p>Based on "ECO'DEEE recyclability and recoverability calculation method" (version V1, 20 Sep. 2008 presented to the French Agency for Environment and Energy Management: ADEME).</p>

Schneider Electric Industries SAS

Country Customer Care Center
<http://www.schneider-electric.com/contact>

35, rue Joseph Monier

CS 30323

F- 92506 Rueil Malmaison Cedex

RCS Nanterre 954 503 439

Capital social 896 313 776 €

www.schneider-electric.com

ENVEOLI2102007_V2-EN

Published by Schneider Electric

© 2019 - Schneider Electric – All rights reserved

07/2021