

Product End of Life Instructions

ZBV LIGHT BLOCK WITH INTEGRAL LED

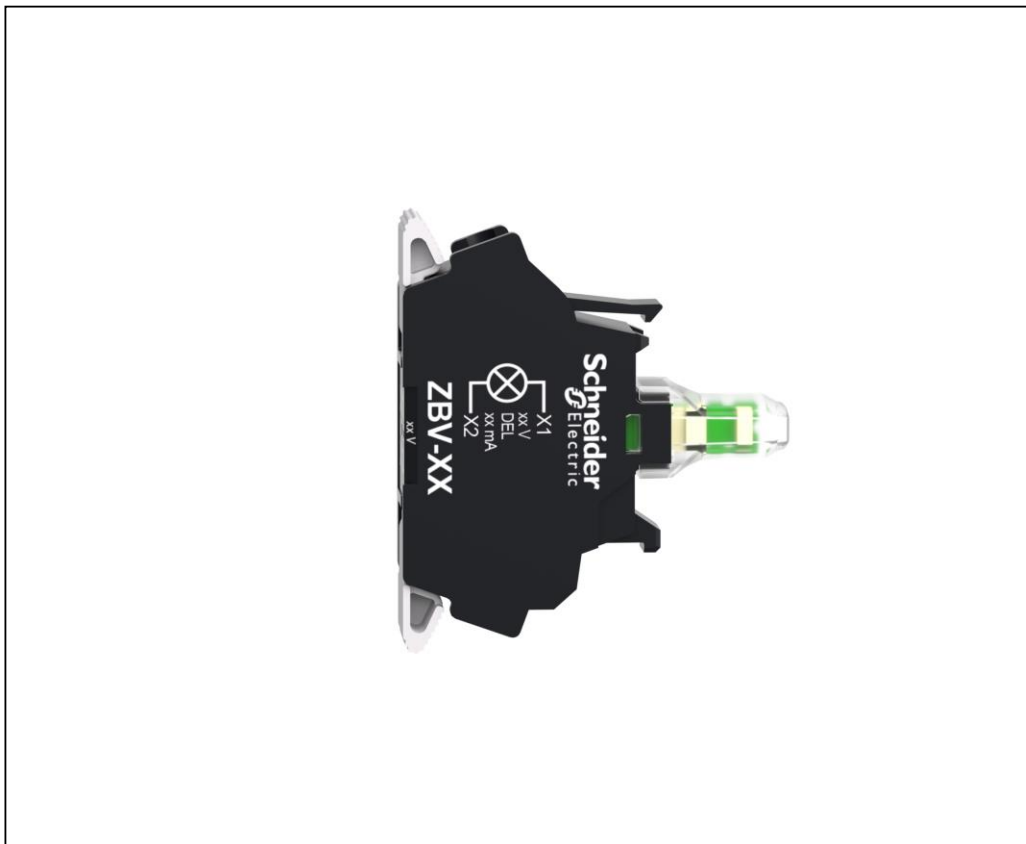

End of Life Instructions

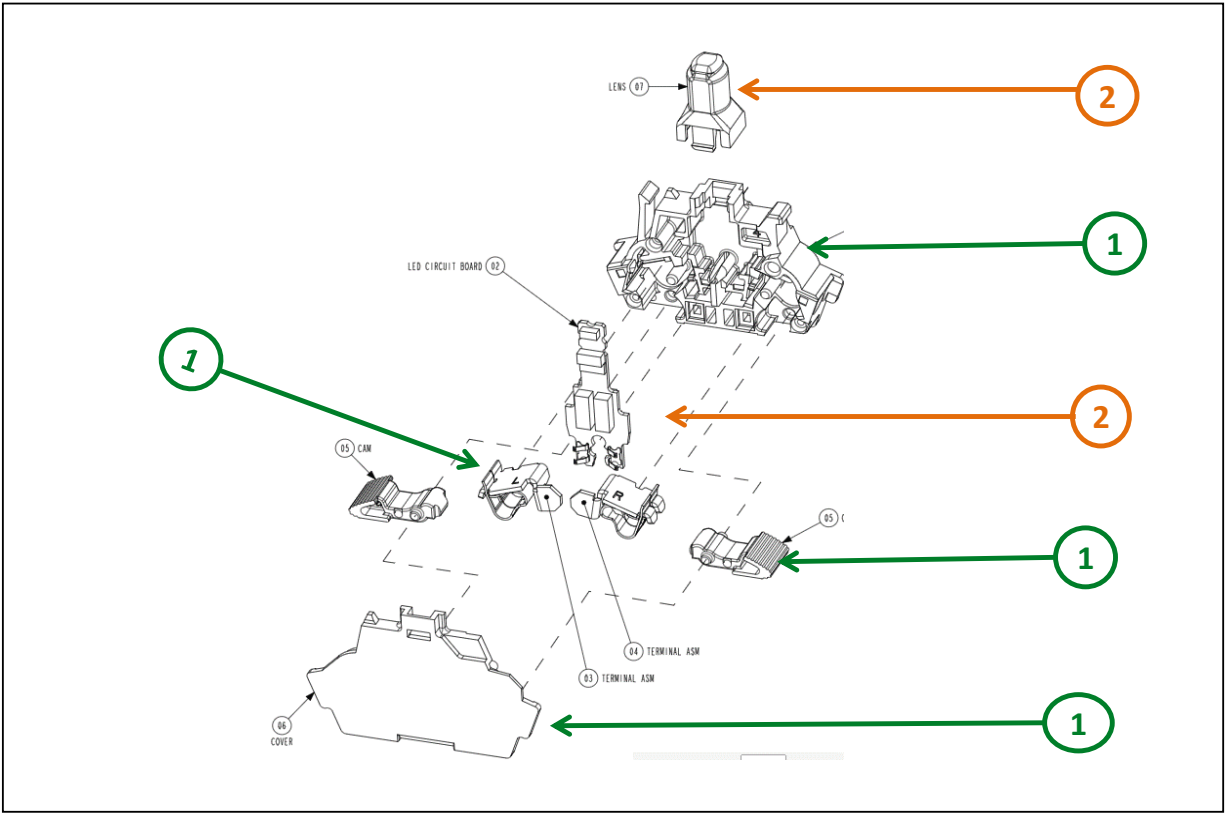

Recommendation	Number on drawing	Component / Material	Weight (in g)	Comment
To be dismantled	1	Cover, Pusher, Housing and Terminals	4.26	Plastic and Metal Parts
To be depolluted	2	Electronic Board (Communication) > 10cm ²	0.6682	PCBA

Product description

Manufacturer identification	Schneider Electric Industries SAS
Brand name	Schneider Electric
Product function	ZBVM15 enables visual distinction of signaling units via illumination by integral LED. It protects operators from unexpected contact with live circuits. It is easily installed and replaced on compatible illuminated push-button or selector switch units via clip together assembly and connected with simple screw-clamp connections
Product reference	ZBVM15
Total representative product mass	4.6 g
Representative product dimensions	30.7mm x 35.4mm x 9.8mm
Accessories	Not required any special accessories for dismantling
Date of information release	04/2023

Additional information

Legal information	This product family is in the scope of European Union directive 2012/19/EU on Waste Electrical and Electronic Equipment (WEEE). The product family must be disposed according to the legislation of the country. This document is intended for use by end of life recyclers or treatment facilities. It provides the basic information to assure an appropriate end of life treatment for the components and materials of the product.	
In case of special transportation: transportation method	There was no need for any special transportation.	
Recyclability potential	15%	Recyclability rate has been calculated based on REEECY'LAB tool developed by Ecosystem, for components/materials not covered by the tool, data from the "ECO'DEEE recyclability and recoverability calculation method" was taken. If no data was found a conservative assumption was used (0% recyclability).

Schneider Electric Industries SAS
Country Customer Care Center
<http://www.schneider-electric.com/contact>
35, rue Joseph Monier
CS 30323
F- 92500 Rueil Malmaison Cedex
RCS Nanterre 954 503 439
Capital social 896 313 776 €

www.se.com

ENVEOLI2302007_V1

Published by Schneider Electric

© 2023 - Schneider Electric – All rights reserved

04/2023