

ComPacT™ NSX100-250
ComPacT™ NSX100-250 DC
PowerPacT™ H-Frame / J-Frame
TeSys™ GV5

Adapter for plug in base
 Adaptateur pour socle
 Adaptador zócalo

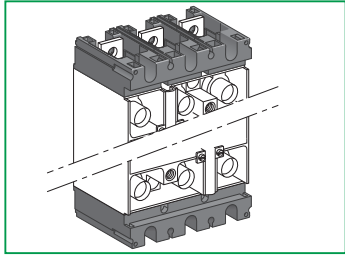

GHD16252AA-07

Schneider Electric Industries SAS

35, rue Joseph Monier
 92500 Rueil Malmaison
 France
 www.se.com

Printed on recycled paper.

© 2024 Schneider Electric.
 All rights reserved.

PLEASE NOTE

- Electrical equipment should be installed, operated, serviced, and maintained only by qualified personnel.
- No responsibility is assumed by Schneider Electric for any consequences arising out of the use of this material.

REMARQUE IMPORTANTE

- L'installation, l'utilisation, la réparation et la maintenance des équipements électriques doivent être assurées par du personnel qualifié uniquement.
- Schneider Electric décline toute responsabilité quant aux conséquences de l'utilisation de cet appareil.

TENGA EN CUENTA

- La instalación, manejo, puesta en servicio y mantenimiento de equipos eléctricos deberán ser realizados sólo por personal cualificado.
- Schneider Electric no se hace responsable de ninguna de las consecuencias del uso de este material.

请注意

- 电气设备的安装、操作、维修和维护工作仅限于合格人员执行。
- Schneider Electric不承担由于使用本资料所引起的任何后果。

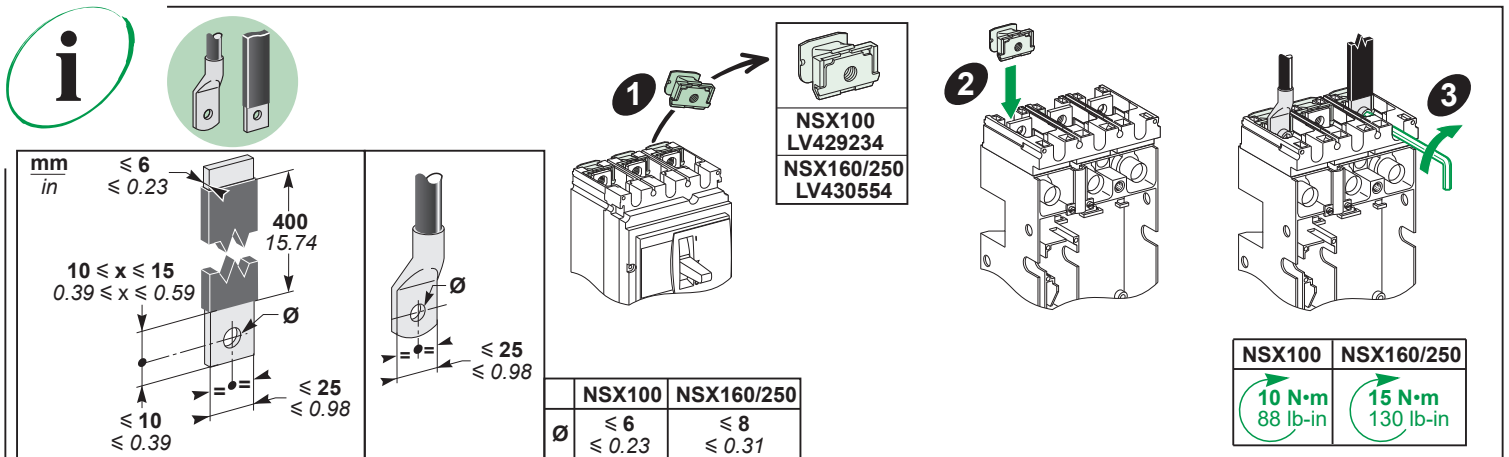
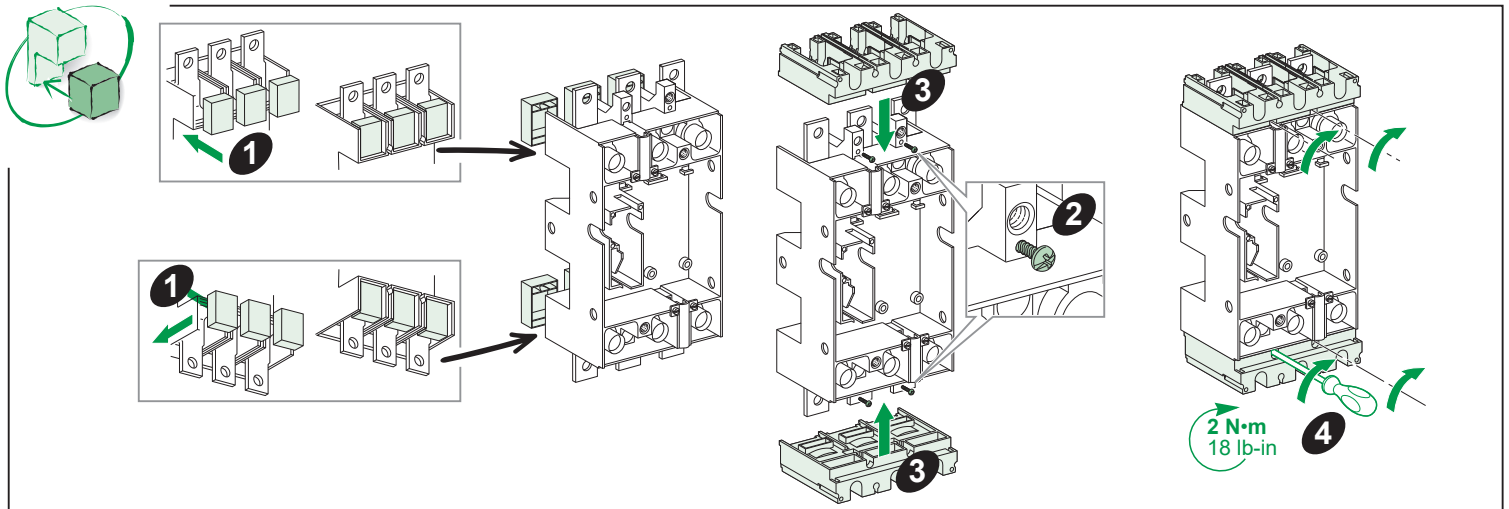
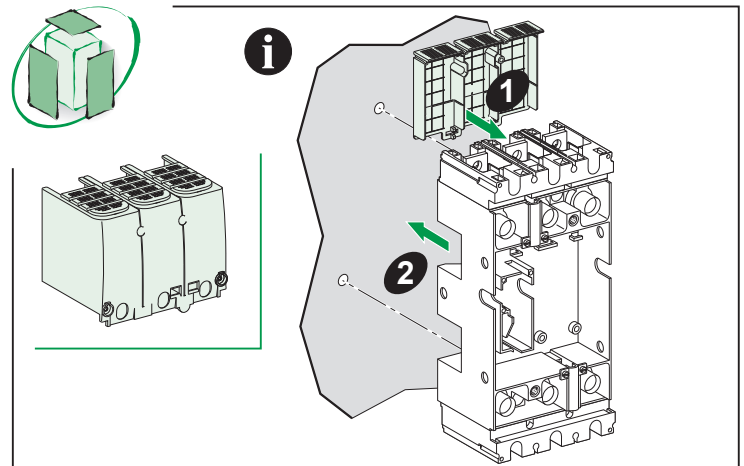
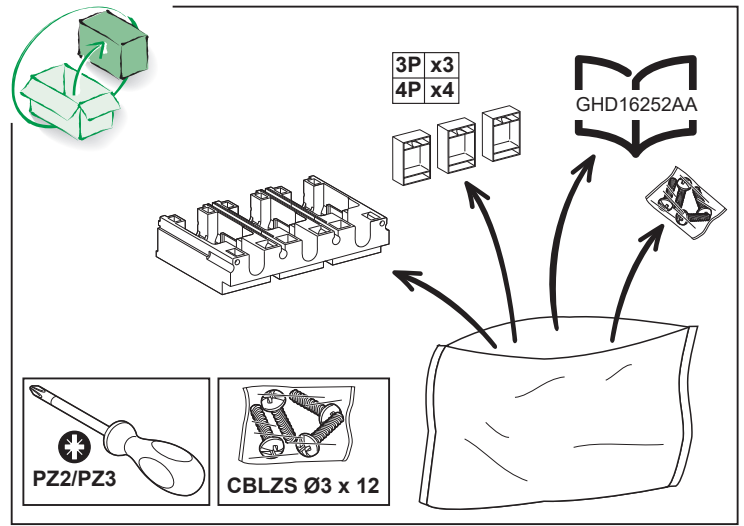

GHD16252AA-07

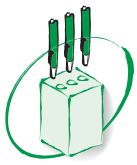

mm
in

NSX100/250

NSX100/250	
25 → 95 mm ² 120 → 185 mm ²	
x2	LV429255 LV429247
x3	LV429227 LV429259
x4	LV429228 LV429260



Aluminium
Aluminium

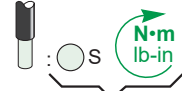

see instruction
1 cable / 2 cables connector

NNZ4765407

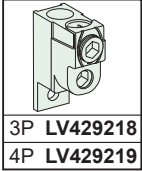
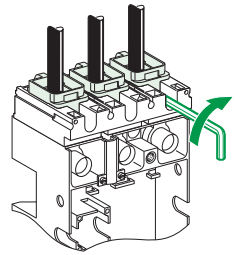

3P LV429218
4P LV429219

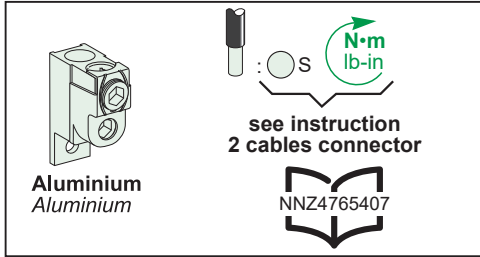

Aluminium
Aluminium

NNZ4765407

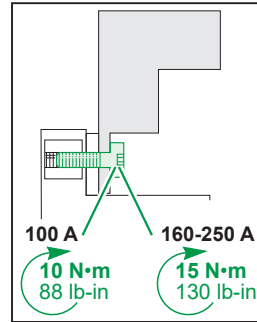

100 A
10 N·m
88 lb-in

160-250 A
15 N·m
130 lb-in

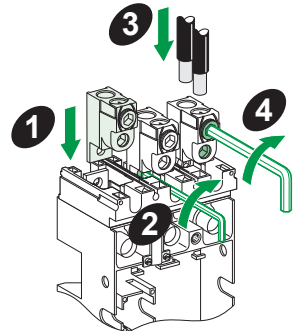

NSX100/160

NSX100/160	
1,5...95 mm ² AWG 16...4/0	
x2	LV429246
x3	LV429242
x4	LV429243

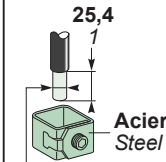

Acier
Steel

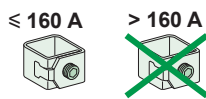

≤ 160 A

> 160 A

S : 1,5...95 mm² Cu / Al
S : AWG 16...4/0 Cu / Al

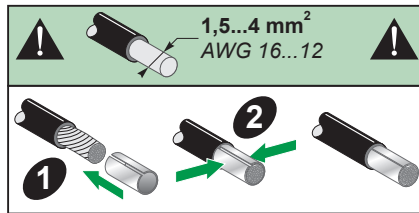

1,5...4 mm²
AWG 16...12

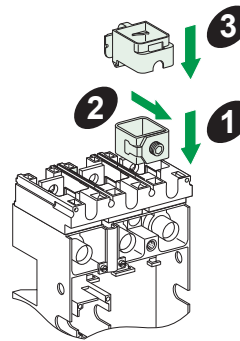

12 N·m
106 lb-in

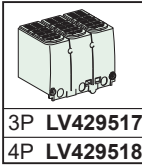

3P LV429517
4P LV429518

Mandatory U ≥ 500 V
Obligatoire U ≥ 500 V
Obligatorio U ≥ 500 V

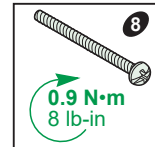
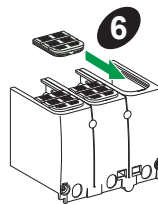
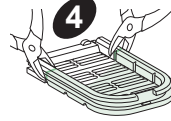
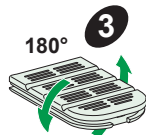
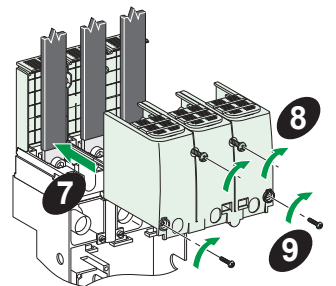
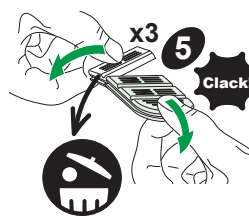
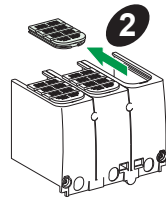
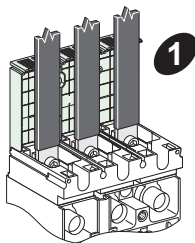

0.9 N·m
8 lb-in



0.9 N·m
8 lb-in

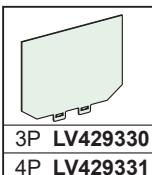

3P LV429330
4P LV429331

Mandatory U ≥ 500 V
Obligatoire U ≥ 500 V
Obligatorio U ≥ 500 V

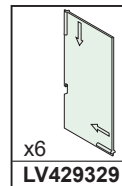
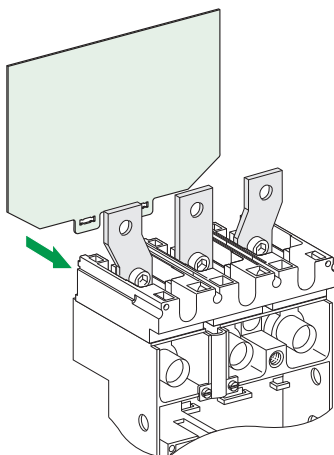

x6
LV429329

